

Contact Clearfield and we'll help you build the kit the exactly fits your application.

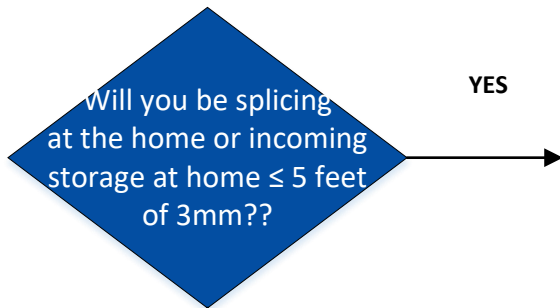

YES

- Splice or Plug-and-Play
- 5 Feet Incoming Slack Storage
- IP-66
- Kit Includes Outgoing Equipment Cables and Adapters
- Cleaning Card

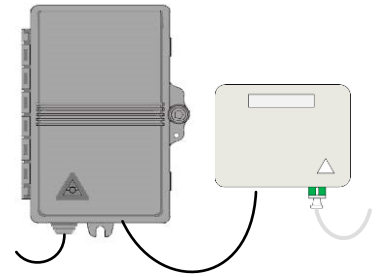

CraftSmart TAP-Splice and CraftSmart Fiber Outlet

NO

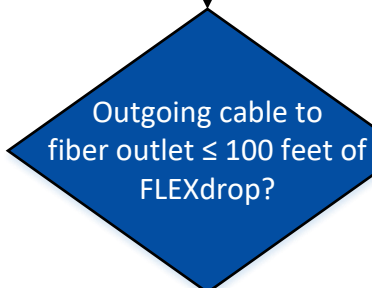

YES

Incoming storage at home is YOURx Breakout?

- 50 Foot Incoming Slack Storage (When Combined With StrongFiber Deploy Reel)
- 100 Foot Max. Outgoing Fiber
- Plug-and-Play
- NEMA 4 Designed
- Kit Includes Outgoing Equipment Cables and Adapters
- Cleaning Card

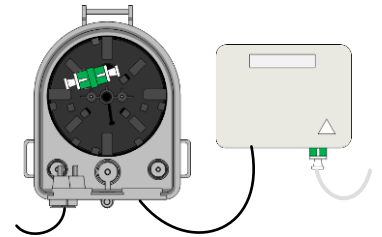

YOURx-TAP and CraftSmart Fiber Outlet

NO

NO

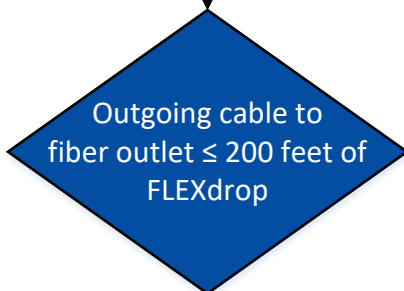

- 100 Foot Incoming Slack Storage
- 200 Foot Max. Outgoing Fiber
- Plug-and-Play
- NEMA 4
- Kit Includes Outgoing Equipment Cables and Adapters
- Cleaning Card

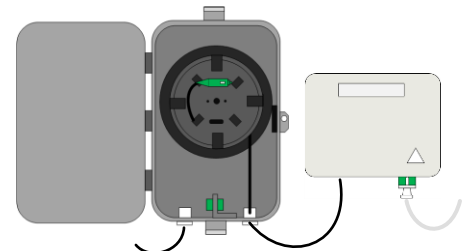

FieldSmart SCD-TAP and CraftSmart Fiber Outlet