

## Application

Carriers are faced with many challenges when cabling MDUs in both existing (brownfield) and new construction (greenfield). One such challenge is how to manage incoming duct, while supporting varying number of subscribers in different configurations with slack management while also reducing installation time. Clearfield's YOURx Flex Box addresses these challenges with a flexible and scalable solution all within a single wall box.

## Description

The YOURx Flex Box is a secure, modular wall box with slide-in aggregator plate that supports multiple cable entries like, individual fiber cables, conduit and microduct in an organized manner. Installers simply push the microduct into the aggregator plate and they are ready to pull fiber. Slack storage is provided for both incoming and outgoing fiber in separate areas to reduce service interruptions when turning up additional subscribers. The drop wheel feature accommodates up to 16 individual drop wheel assemblies with each drop wheel supporting up to a 200' (60.96 m) of FieldShield<sup>®</sup> StrongFiber storage. Using the Clearview<sup>®</sup> Cassette or Drop Wheel assembly allows for a plug-and-play concept which reduces installation time.

## Features and Benefits

### Integrity

- Utilizes the Clearview Blue Cassette, Clearview xPAK and FieldShield Drop Wheel
- 1" inside mounting hole pattern for multiple applications
- Dual snap ensures lid secures to box

### Protection

- NEMA 4 Rated
- Secured with 216 can wrench bolt
- Security screw with ability to secure with padlock
- Gasket seal
- Grounding lug included

### Access

- Easy to install with both internal and external mounting holes
- Top and bottom entry/exit points

### Investment

- Scalable
- Slide-in aggregator plates eliminate the need for additional duct organizer
- Clearview Cassette, Clearview xPAK and Drop Wheels

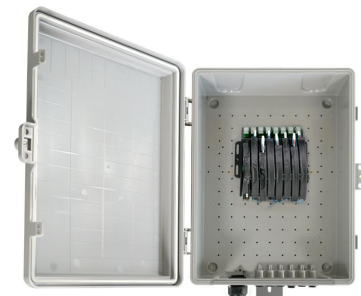
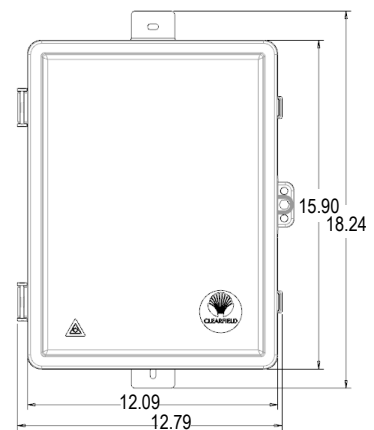

## Technical Specifications

YOURx Flex Box	
Dimensions	18.24(H) with tab x 12.00(W) x 5.84(D) Without Tabs: 15.66(H)
Material	UV rated, flame retardant, V0 rated
Port Density	Four cassettes (48 ports), up to 16 in drop wheels
Connectivity Types	Clearview <sup>®</sup> Blue, Drop Wheel
Aggregator Plate	Combo Plate - microduct supports (24) 10/6mm or (24) 8.5/6mm. Universal Plate - lay in applications. Universal Combo - lay in with microduct. PON Plate - microduct (32) 10/6mm or (32) 8.5/6mm.
Drop Wheel	Fiber type - FieldShield <sup>®</sup> StrongFiber
Drop Wheel Connector	Pullable SC/APC and SC/UPC to standard SC/APC and SC/UPC
Drop Wheel Cable Length	200 feet (60.96 m) FieldShield StrongFiber
Drop Wheel Material	Black Thermoplastic

### Modules



Patch and Splice Cassette



MPO Cassette



Empty Cradle Assembly No Drop Wheels - MPO



Empty Cradle Assembly No Drop Wheels - Splitter



Cradle Assembly with Drop Wheels Installed

### Plates



Blank Plate Supports up to 9<sup>3</sup>/<sub>4</sub>" sealcons



Universal Plate Not Outdoor Rated



Combo Plate With Universal Grommet Plate - Not Outdoor Rated



Combo Plate Includes 3/4" Sealcon



PON Plate Includes 1/2" Sealcon

## Configured Part Numbers

W Q - - - - - Z Z - - - - -  
 1 2 3 4 5 6 7

#### 1 Select Module Type

- B = Cassette — Customer Splice
- C = Empty Cradle Assembly Input Male MPO
- E = Empty Cradle Assembly with Splitter, Input SC/APC
- M = Loaded Cradle Assembly Input Male MPO
- N = Cassette — Input Male MPO
- S = Loaded Cradle Assembly With Splitter, Input SC/APC

#### 2 Select Output Port Count

- If Cassette:**
- 012 = 12 ports
  - 024 = 24 ports
  - 036 = 36 ports
  - 048 = 48 ports
- If Drop Wheel:**
- 004 = 4 ports
  - 008 = 8 ports
  - 012 = 12 ports
  - 016 = 16 ports

#### 3 Select Output Connector Type

- If Cassette:**
- A = SC/UPC
  - C = SC/APC
  - F = LC/UPC
  - H = LC/APC
- If Drop Wheel:**
- A = SC/UPC
  - C = SC/APC

#### 4 Select Fiber Mode: Type Inside Module

- 1 = Cassette or Cradle SM Loose Tube
- 2 = Cassette SM Ribbon

#### 5 Select Jacket Construction

- F = Cassette — Loose Tube
- S = Drop Wheel — 900 μm StrongFiber
- Z = Cassette — Ribbon

#### 6 Select Aggregator Plate

- B = Blank Plate
- C = Combo Plate 10/6mm Microduct
- E = Combo — No FlexPorts
- H = Universal Blank
- J = Combo Plate with Universal Grommet
- K = Combo Plate 8.5/6mm Microduct
- P = PON Plate

\* 10/6 mm or 8.5/6mm FlexPorts will match the port count selected in #2.

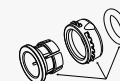

#### 7 Select Drop Wheel Length

- 200F = StrongFiber on Drop Wheel
- Leave Blank = If using Cassette or Drop Wheel Cradle

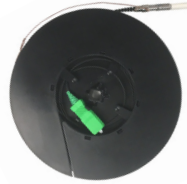

Individual Drop Wheel

Part Number	Description
DW-001-SCU-SCU 200F	Drop wheel, loaded with loaded with 200 feet (60.96 m) FieldShield StrongFiber, terminated with pullable SC/UPC to SC/UPC connectors
DW-001-SCA-SCA 200F	Drop wheel, loaded with loaded with 200 feet (60.96 m) FieldShield StrongFiber, terminated with pullable SC/APC to SC/APC connectors

## Pre-Configured Empty Box Part Numbers

Part Number	Description
FDP-xWBF-BPLATE	Empty Flex Box with blank plate and cable management kit.
FDP-xWBF-CPLATE	Empty Flex Box with combo plate and cable management kit. No FlexPort fittings installed.
FDP-xWBF-CPLATE-24	Empty Flex Box with combo plate and cable management kit. Loaded with 24 10/6mm FlexPort fittings.
FDP-xWBF-CPLATE-24-85	Empty Flex Box with combo plate and cable management kit. Loaded with 24 8.5/6mm FlexPort fittings.
FDP-xWBF-PPLATE-32	Empty Flex Box with PON plate and cable management kit. Loaded with 32 10/6mm FlexPort fittings.
FDP-xWBF-PPLATE-32-8.5MM	Empty Flex Box with PON plate and cable management kit. Loaded with 24 8.5/6mm FlexPort fittings.
FDP-xWBF-UPATE	Empty Flex Box with universal plate and cable management kit. Indoor rated.
FDP-xWBF-UCPLATE	Empty Flex Box with universal grommet combo plate with microduct ports and cable management kit. No FlexPort fittings installed, Indoor rated.
FDP-XWBF-UCPLATE-16	YOURx FieldSmart Flex Box, 48 Max. Cap., Universal Combo Plate, Loaded with (16) 10/6 Fittings Installed, Includes Hardware Kit, Indoor rated.
FDP-XWBF-UCPLATE-04-8.5-01	YOURx FieldSmart Flex Box, 48 Max. Cap., Universal Combo Plate, Loaded with 4 FlexPort, Push to Connect, 8.5MM, Indoor rated.
FDP-XWBF-UCPLATE-24-8.5-01	YOURx FieldSmart Flex Box, 48 Max. Cap., Universal Combo Plate, Loaded with 24 FlexPort, Push to Connect, 8.5MM, Indoor rated.

## Pre-Configured Splice Box (Indoor Only)

Part Number	Description
FDP-XWBF-UPATE-SPLICE-01	YOURx FieldSmart Flex Box, 48 Max. Cap., Universal Plate, Hardware Kit and Ship Along 48 Position Splice Tray

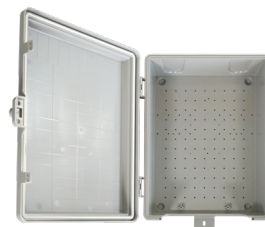



FlexPort Fitting for Combo Plate,  
PON Plate PLATE and Universal  
Combo Plate. 10mm QTY: 1  
PN 016280



FlexPort Fitting for Blank Plate, 10  
mm Qty: 1 (Requires Drilled 1/2 Hole)  
P/N 018835

## Accessories

Part Number	Description
016280-06	FlexPort Fitting for Combo and Duct Plate, 10 mm, Quantity - 6
016280-12	FlexPort Fitting for Combo and Duct Plate, 10 mm, Quantity - 12
018835	FlexPort Fitting for Blank Plate (Requires Drilled 1/2 Hole), 10 mm, Quantity - 1
018432	Plug, FlexPort, 10 mm (Hard to remove, install with caution)

## Configured Part Numbers with Pigtail Assembly

W Q B - \_\_\_\_\_ - \_\_\_\_\_ - \_\_\_\_\_ Z Z XXXXF or XXXXM

1
2
3
4
5

**1 Select Output Port Count**

012 = 12 ports  
024 = 24 ports  
036 = 36 ports  
048 = 48 ports

**3 Select Fiber Jacket Construction**

1 = Singlemode, Loose Tube  
2 = Singlemode, Ribbon

**5 Select Aggregator Plate**

B = Blank Plate  
C = Combo Plate — with Flexports  
E = Combo Plate — NO Flexports

**2 Select Output Connector Type**

A = SC/UPC  
C = SC/APC  
F = LC/UPC  
H = LC/APC

**4 Select Cable Type**

A = IFC Riser  
B = OSP Riser Rated  
C = IFC Plenum  
E = OSP (Non-rated)  
M = OSP (Armored, Non-rated)  
T = FLATdrop (Non-toneable)  
W = FieldShield

**XXXXF = Length in Feet XXXXM = Length in Meters**

*Example: 200 Ft. Cable = 0200F*

\* 10/6mm Flexports will match the port count selected in #1

# YOURx<sup>®</sup>

## Flex Box - Distributed TAP Configurations



### Boxes

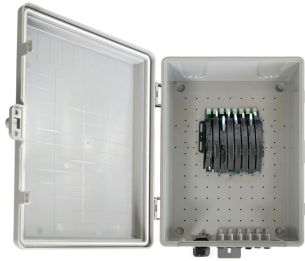

Cassette or Cradle Box

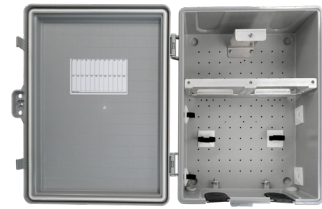

LGX Box

### Modules



Cassette



Empty Cradle Assembly  
No Drop Wheels - Splitter  
MON Option Not Available



Cradle Assembly with Drop  
Wheels Installed  
MON Option Not Available



LGX Module  
MON Option Not Available

### Plates



Blank Plate  
Supports 2 3/8 Hole



Universal Plate



Combo Plate With  
Universal Grommet  
Plate



Combo Plate  
Includes 3/4" Sealcon  
Plate

### Optical TAP/Express Loss Values

Insertion Loss Does Not Include Connectors

Express/TAP Split Ratio	2 Port Drop & Express		4 Port Drop & Express		8 Port Drop & Express	
	Express IL Max (dB)	Drop IL Max (dB)	Express IL Max (dB)	Drop IL Max (dB)	Express IL Max (dB)	Drop IL Max (dB)
90/10	1.2	14.4	1.1	19.1	1.1	22.4
85/15	1.5	13	1.5	17.7	1.5	21
80/20	1.8	11.2	1.7	16.1	1.7	19.4
70/30	2.4	10	2.4	14	2.4	17.2
60/40	3.2	8.4	3.2	12.6	3.2	15.9
50/50	3.9	7.5	4.1	11.5	4.1	14.8

# YOURx<sup>®</sup>

## Flex Box - Distributed TAP Configurations



### Optical TAP/Express with MON Option Loss Values

Insertion Losses Listed Do Not Include Connectors

Express/ TAP Split Ratio	2 Port Drop with EXP & MON			4 Port Drop with EXP & MON			8 Port Drop with EXP & MON		
	Express IL Max (dB)	Drop IL Max (dB)	MON IL Max (dB)	Express IL Max (dB)	Drop IL Max (dB)	MON IL Max (dB)	Express IL Max (dB)	Drop IL Max (dB)	MON IL Max (dB)
90/10	1.4	16.2	21.0	1.4	19.2	21.0	1.4	22.2	21.0
85/15	1.6	14.3	21.0	1.6	17.3	21.0	1.6	20.3	21.0
80/20	2.1	11.5	21.0	1.8	15.4	21.0	1.8	18.5	21.0
70/30	2.7	10.3	21.0	2.4	12.9	21.0	2.3	16.3	21.0
60/40	3.1	9.7	21.0	3.1	12.7	21.0	3.1	15.7	21.0
50/50	4.4	8.5	21.0	4.4	11.5	21.0	4.4	14.5	21.0

### Configured Part Numbers with Distributed TAP

W Q T      -           C - C                -      Z Z               

1   
 2   
 3   
 4   
 5   
 6

**1 Select Module Type**

B = Cassette  
 E = Empty Cradle (No Monitor Option)  
 L = LGX Module (No Monitor Option)  
 S = Loaded Cradle (No Monitor Option)

**2 Select Drop Port Count**

02 = 2 Drop  
 04 = 4 Drop  
 08 = 8 Drop

**3 Select TAP/Express Ratio**

9010 = 90/10  
 8515 = 85/15  
 8020 = 80/20  
 7030 = 70/30  
 6040 = 60/40  
 5050 = 50/50

**4 Select Monitor Port**

M = SC/APC Monitor Port  
 Z = No Monitor Port

**5 Select Aggregator Plate**

B = Blank Plate  
 C = Combo Plate 10/6mm Microduct  
 H = Universal Blank  
 J = Combo Plate with Universal Grommet  
 K = Combo Plate 8.5/6mm Microduct  
*\* 10/6 mm or 8.5/6 mm FlexPorts will match the port count selected in #2*

**6 Select Drop Wheel Length**

200F = StrongFiber on Drop Wheel  
 Blank = If using cassette, empty cradle or LGX module

#### Example: WQTS-04C-C8020Z-JZZ 200F

YOURx FlexBox with 4 SC/APC drops 80/20 distributed TAP splitter cradle assembly, combo aggregator plate with universal grommet, (4) loaded 200 ft. StrongFiber Drop Wheels